

Service Updates

Pickup Head Conversion Kits

Section 1

6 Row 30 and 8 Row 22 Complete 8 Tube Pickup Head Conversion Kit 2-3

8 Row 30 Complete 8 Tube Pickup Head Conversion Kit 4-5

Return to this page by clicking the upper right corner of any page in this section.

COMPLETE 8-TUBE PICKUP HEAD

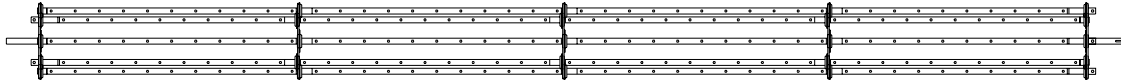

901400-00 (174-3/16" LG.)
(1 REQUIRED)

CAM TRACK SIDE PLATES

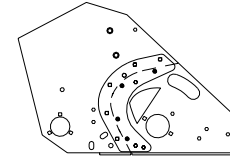

901523 (RH)
(1 REQUIRED)

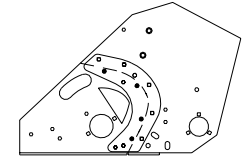

901524 (LH)
(1 REQUIRED)

6-30 & 8-22 COMPLETE 8-TUBE PICKUP HEAD CONVERSION KIT

CAM TRACKS

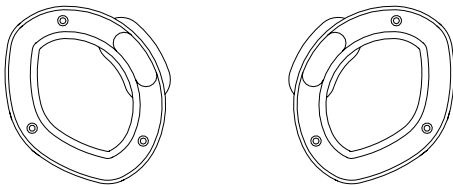

103096
(2 REQUIRED)

FLANGETTES, BEARINGS & SPACERS

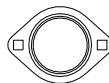

106050
(2 PR. REQUIRED)

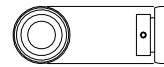

102060
(2 REQUIRED)



901484
(2 REQUIRED)

TAPER LOCK SPROCKET & HUB

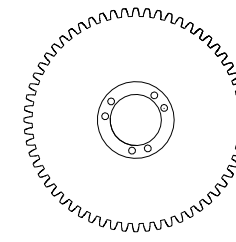

119148
(1 REQUIRED)



119159
(1 REQUIRED)

405031

6 Row 30 and 8 Row 22**Complete 8-Tube Pickup Head Conversion Kit (405031)****Parts List**

<u>Item No.</u>	<u>Part No.</u>	<u>Qty</u>	<u>Description</u>
1.	901400-00	1	Complete 8-Tube Pickup Head Assembly (174 ³ / ₁₆ ") (6-30 & 8-22)
2.	901523	1	R.H. Side Plate Assembly (1 ¹ / ₄ " PUH Bearings)
3.	901524	1	L.H. Side Plate Assembly (1 ¹ / ₄ " PUH Bearings)
4.	103096	2	Cam Track, Universal
5.	106050	2 pr.	Flangette, 72 MST
6.	102060	2	Bearing, 1 ¹ / ₄ " Insert
7.	901484	2	Spacer, Pickup Head (1 ¹ / ₄ " I.D.)
8.	119148	1	Sprocket, 50Q60 Taper Lock
9.	119159	1	Hub, 1 ¹ / ₄ " Bore, Taper Lock (SK Series)

COMPLETE 8-TUBE PICKUP HEAD



901440 (234-3/16" LG.)
(1 REQUIRED)

CAM TRACK SIDE PLATES

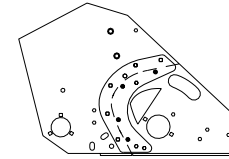

901523 (RH)
(1 REQUIRED)

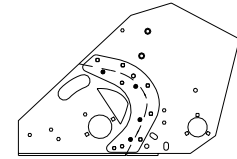

901524 (LH)
(1 REQUIRED)

8-30 COMPLETE 8-TUBE PICKUP HEAD CONVERSION KIT

CAM TRACKS

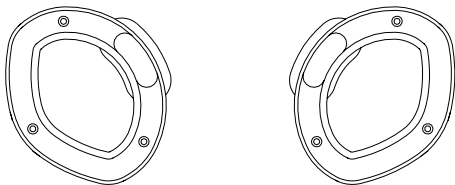

103096
(2 REQUIRED)

FLANGETTES, BEARINGS & SPACERS

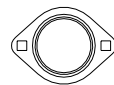

106050
(2 PR. REQUIRED)



102060
(2 REQUIRED)



901484
(2 REQUIRED)

TAPER LOCK SPROCKET & HUB

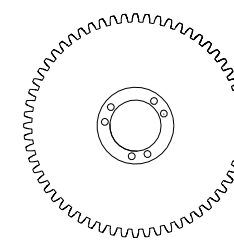

119148
(1 REQUIRED)



119159
(1 REQUIRED)

405032

8 Row 30 Complete 8-Tube Pickup Head Conversion Kit (405032)

Parts List

<u>Item No.</u>	<u>Part No.</u>	<u>Qty</u>	<u>Description</u>
1.	901440	1	Complete 8-Tube Pickup Head Assembly (234 ³ / ₁₆ ") (8-30)
2.	901523	1	R.H. Side Plate Assembly (1 ¹ / ₄ " PUH Bearings)
3.	901524	1	L.H. Side Plate Assembly (1 ¹ / ₄ " PUH Bearings)
4.	103096	2	Cam Track, Universal
5.	106050	2 pr.	Flangette, 72 MST
6.	102060	2	Bearing, 1 ¹ / ₄ " Insert
7.	901484	2	Spacer, Pickup Head (1 ¹ / ₄ " I.D.)
8.	119148	1	Sprocket, 50Q60 Taper Lock
9.	119159	1	Hub, 1 ¹ / ₄ " Bore, Taper Lock (SK Series)